

ISS RFID Floor Mat-300



Product overview

ISS RFID floor mat-300 is a high performance modular RFID floor mat that integrates **multiple UHF RFID antennas** inside a floor mat, for tracking people or objects.

RFID floor mat-300 is able to withstand 1,100 lbs.

The **antennas** have circular polarization and a radiation pattern characterized by a 40° beam width in one direction and a 90° beam width in the perpendicular direction (curtain beam shape).

This radiation pattern makes this system ideal for RFID **applications** such as loss prevention systems, portals, corridors, doors, etc.

Options

Floor mat modules can be combined in multiple ways giving the customers high flexibility regarding the width of protected areas. After drilling the modules to the floor, the mat can be covered by any fabric.

Benefits:

- Excellent performance
- Non visible antennas
- Easy to install
- High flexibility

Applications:

- Loss prevention systems
- People tracking at exhibitions
- Item tracking between backroom and sales floor at retail stores
- Warehouses
- People and object tracking in general at doors or corridors

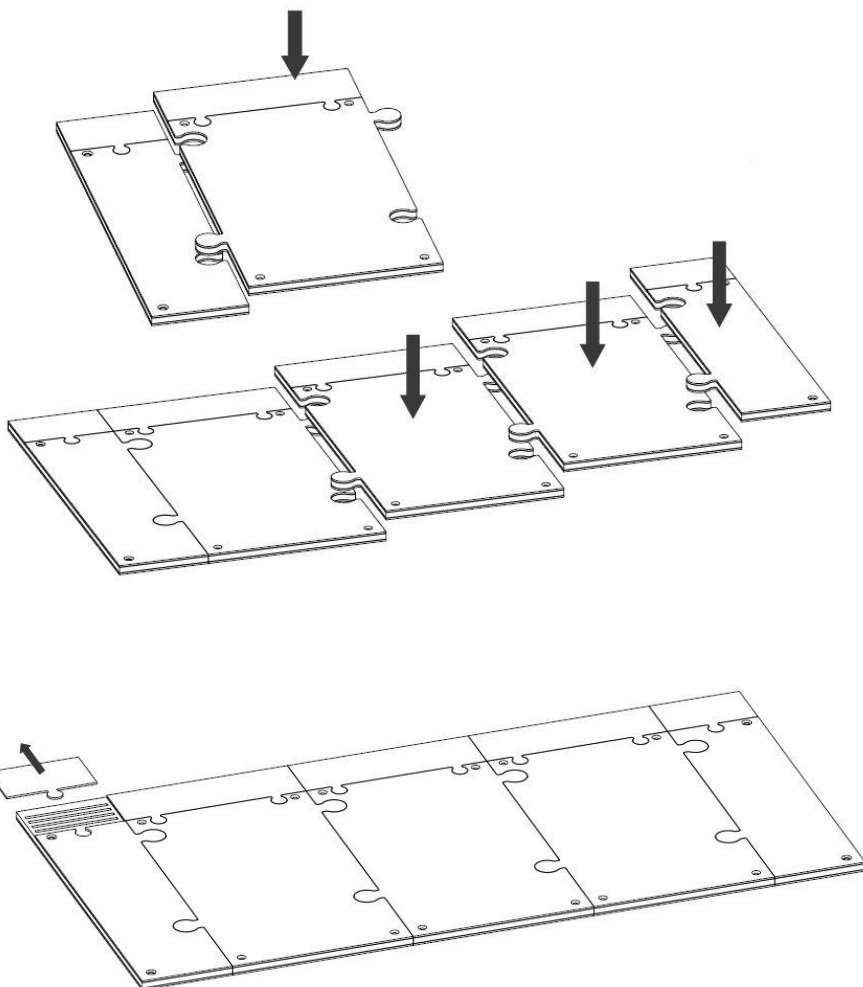



Specifications

Operating Frequency	902 - 928 MHz (FCC part 15)
Operating Detection distance	Up to 10 ft
Radiation pattern	Fan beam
Gain of each antenna	6 dBi
Beam width of each antenna	40° / 90°
Polarization	Circular
Cables and connectors	cables with SMA female connectors
Sizes	<ul style="list-style-type: none">• Right ending module: 23.6 inches x 5.9 inches• Antenna module: 23.6 inches x 11.8 inches• Separation module 12 in: 23.6 inches x 11.8 inches• Separation module 6 in: 23.6 inches x 5.9 inches• Left ending module: 23.6 inches x 5.9 inches
Height	0.6 inches
Weight	<ul style="list-style-type: none">• Right ending module: 21.16 oz• Antenna module: 56.44 oz• Separation module 30 cm: 42.33 oz• Separation module 15 cm: 21.16 oz• Left ending module: 21.16 oz
Temperature range	-68°F to +131°F

Radiation pattern of each antenna

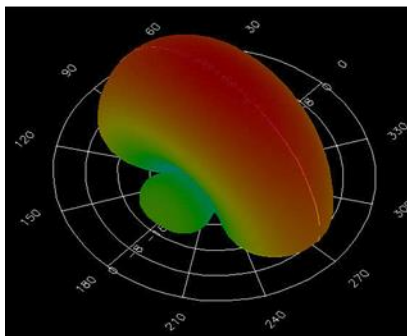



Mechanical specifications

- Right ending module

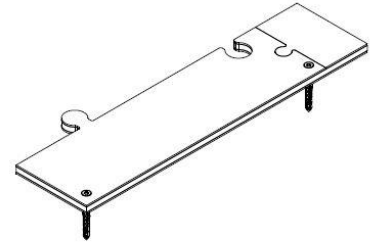
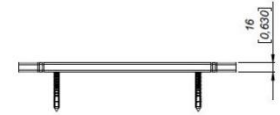
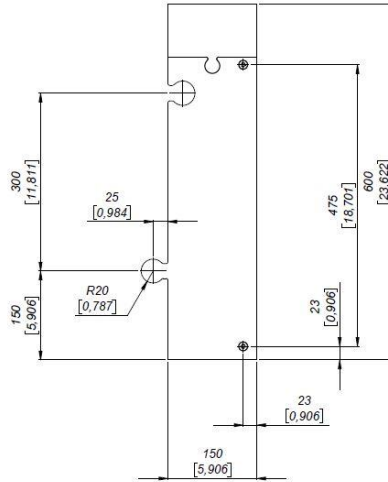

Units in millimeters [inches]

- Left ending module

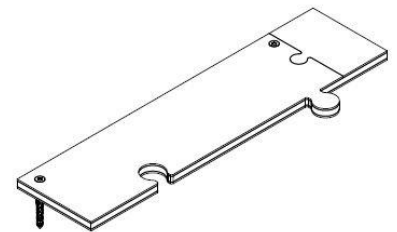
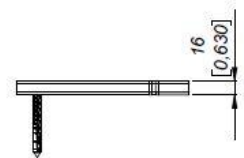
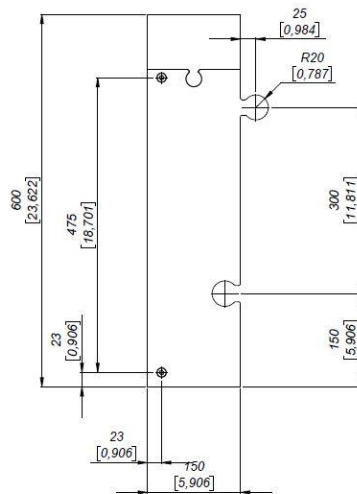

Units in millimeters [inches]

- Antenna module

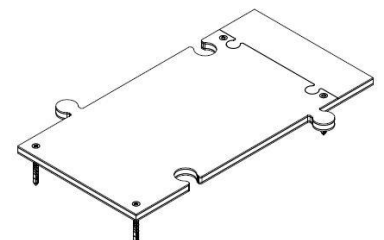
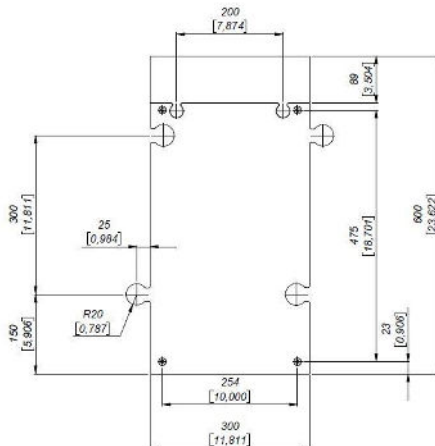

Units in millimeters [inches]



Mechanical specifications

- Separation module, 6 in width

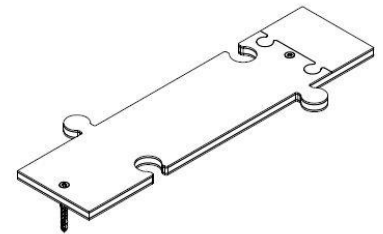
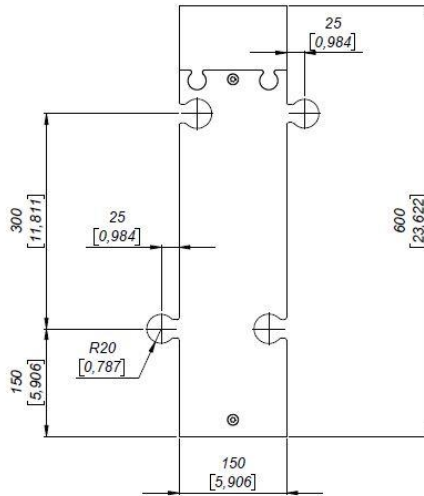

Units in millimeters [inches]

- Separation module, 12 in width

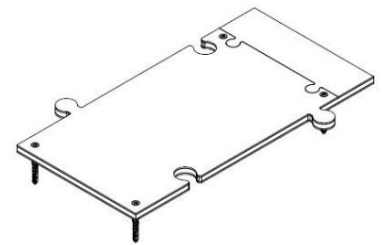
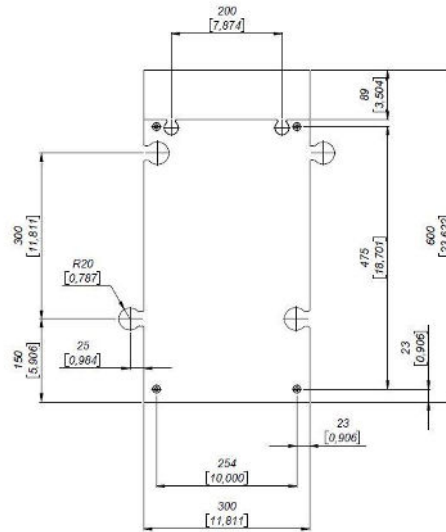

Units in millimeters [inches]